

Instructions For:

# Superstrong A-Frame



## Product Specifications

Graphic should be printed on rigid substrate.  
Graphic Installation requires screws or zip-ties (not included)

Display:	Graphic Size:	Footprint Size:
AFSS24	24" W x 18" H	24.25" W x 18.5" D
AFSS36	24" W x 36" H	24.25" W x 22.5" D

## Product Parts

- 1 - A-Frame
- 2 - Handle
- 3 - Chain
- 4 - Graphic Frame Edge
- 5 - Holes

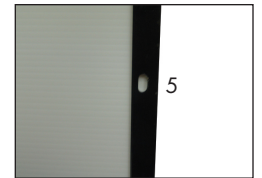
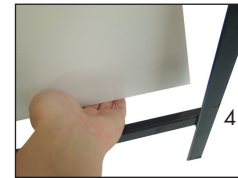
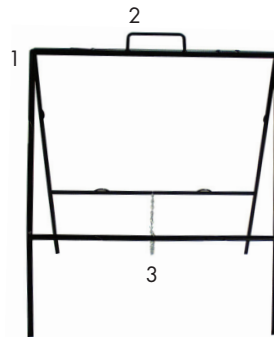

### Step 1

Take the A-Frame (1) out of the box.

### Step 2

Use the Handle (2) to carry the A-Frame (1) to the desired location. Separate the front and back segments of the A-Frame (1) until the Chain (3) is taut.



### Step 3

Slide the Graphic in behind the Graphic Frame Edge (4) and mark the Holes (5) on the Graphic. Remove the Graphic, and pre-drill the marked locations of the holes on the Graphic. Replace the Graphic within the Graphic Frame Edge, and insert screws or zip-ties to secure the graphic in place.

