

Product Specifications

Viewable Graphic Size: 13.5" to 23.5 W x 72", 73", & 74" H (1" increments for height & width)
 Graphic Finishing: 3.5" Top and Bottom Pole Pocket
 Color: Black
 Graphic Template Available



Product Parts

- 1 - Feet (x2)
- 2 - Top Vertical Poles (x2)
- 3 - Bottom Vertical Poles (x2)
- 4 - Horizontal Pole Centers (x2)
- 5 - Horizontal Pole Ends (x4)
- 6 - Large Hex Key
- 6a - Large Hex Screws (x2)
- 7 - Small Hex Key
- 7a - Small Hex Screws (x4)
- 8 - Springs (x2)

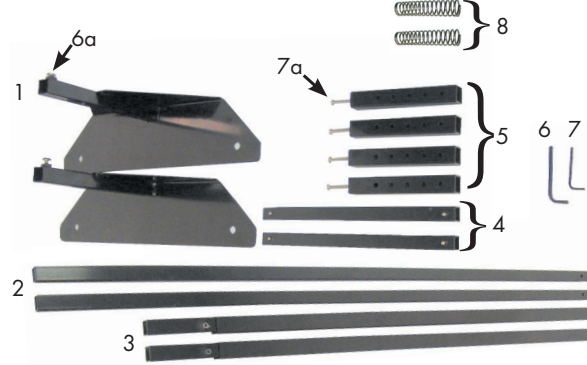

Display Set-Up

Step 1

Attach a Horizontal Pole End (5) to a Foot (1) using the Small Hex Key (7) and a Small Hex Screw (7a). Be sure that the holes are facing up.

Note that there are 3 height options.

Repeat Step 1 on the second Foot.



Step 2

Being sure that the release buttons are facing up, Insert one Horizontal Pole Center (4) into the Horizontal Pole Ends (5).

Adjust the width of the base to only slightly wider than your artwork.

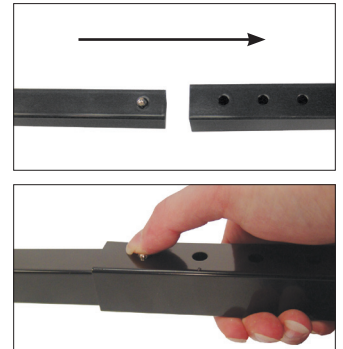

Step 3

Place the base, adjusted to the width of your artwork, where you plan to install it. Mark the holes for the bolts.

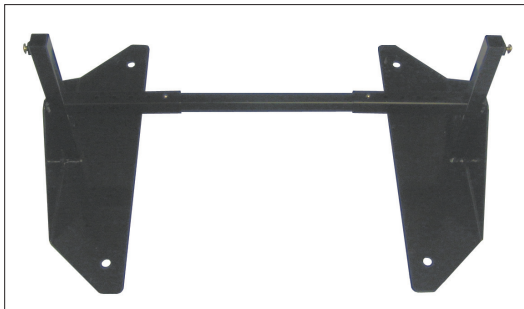

Step 4

Being sure that the small reinforced indentation is facing the Hex Screw, Insert each Bottom Vertical Pole (3) into the tops of the Feet (1) and tighten the Large Hex Screws (6a) using the Large Hex Key (6).

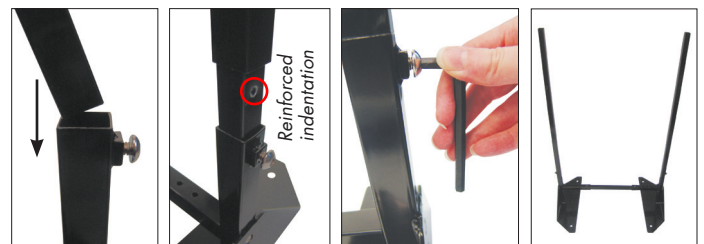

Display Set-Up Continued...

Step 5

Attach one Horizontal Pole End (5) to a Top Vertical Pole (2) using the Small Hex Screw (7a) and the Small Hex Key (7). (Leave the last Horizontal Pole End (5) separate for now)

Be sure that the holes are facing the long end of the Top Vertical Pole. Insert the Horizontal Pole Center (4) into both Horizontal Pole Ends (5) and adjust the width to match the base.



Step 7

Insert one Spring (8) into each Bottom Vertical Pole (3).

Insert the Top Vertical Poles (2) into the Bottom Vertical Poles (3).

Unscrew the Small Hex Screws on the base and remove the Horizontal Pole Ends and Center (4 & 5) as one piece.

Insert the Horizontal Pole Ends and Center into the Bottom Pole Pocket and re-attach to the Feet.

Step 6

Lay the Banner on a flat surface. Insert the Top Horizontal Pole Center and Ends (4 & 5) into the Top Pole Pocket. Attach the final Horizontal Pole End (5) (already attached to the Horizontal Pole Center and inside the Top Pole Pocket) to the final Top Vertical Pole (2) using the Small Hex Key (7) and Small Hex Screw (7a).

Bolt the Feet (1) into the cement.



Storage

Store in a cool dry location.

Care

To clean, wipe with damp cloth.