

Instructions For:

Bamboo Easel



Product Specifications

Recommended Graphic: 20" W x 27" H
Maximum Graphic: 30" W x 41" H
Graphic should be printed on rigid substrate or held in a frame.
Foot Print Dimensions: 35" W x 29" D

Product Parts

- 1 - Top Frame Tray Support
- 2 - Right Leg
- 3 - Back Leg
- 4 - Left
- 5 - Main Screw
- 6 - Screw Handle
- 7 - Wing Nuts w/ Screws
- 8 - Bottom Frame Trays
- 9 - Leather Strap



Step 1

Take all parts out of the bag.
Unfasten the Leather Strap (9).
Lay the easel on its back on the floor.



Step 2

Spread the Left Leg (4) and Right Leg (2) out from the Back Leg (3) so that their tops sit flat against the Top Frame Tray Support (1).



Step 3

Screw the Screw Handle (6) into the Main Screw (5).
Tighten the Main Screw until nearly tight.

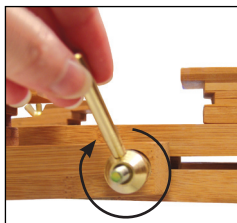
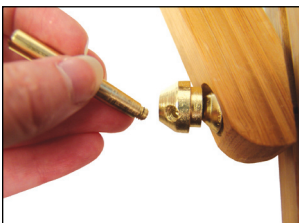

Step 4

Partially loosen the lower Wing Nuts (7) on both the Right and Left Legs (2 and 4) and on the back of the Back Leg (3). Extend the legs to the desired height, and tighten the Wing Nuts.

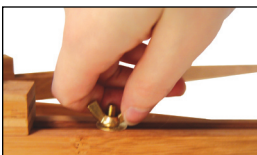

Step 5

Stand the easel upright, pushing the Back Leg (3) back, and pulling the Left Leg (4) and the Right Leg (2) evenly forward.

Step 6

Partially loosen the Wing Nuts (7) on the Frame Trays (8) located on Right and Left Legs (2 and 4). Slide the two Frame Trays down to the desired height of the bottom of your artwork, and tighten the Wing Nuts.

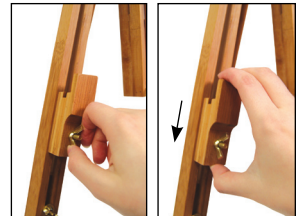

Step 7

Be sure that the Top Frame Tray Support (1) is leaning back at the same angle as the Left and Right Legs. Adjust the height of the Top Frame Tray Support so that the bottom platform is in line with the two bottom Frame Trays (8). Fully tighten the Main Screw (5) and remove the Screw Handle (6).



Step 8

Place your artwork on the easel. Partially loosen the Wing Nut (7) on the Frame Tray (8) located on the Top Frame Tray Support (1). Slide the Frame Tray down to the top of your artwork, and tighten the Wing Nuts.

