

Product Specifications

Color: Red and Blue
Footprint Dimensions: 3.5" w x 16.5" h x 9.25" d
Weight: 23 lbs.
Acceptable Grommet Die Sizes: #0, #1, #2, #3
#2 Grommet Die Included (Pre-installed)

Product Parts

- 1 - Grommet Machine
- 2 - Top Grommet Die*
- 3 - Bottom Grommet Die*

*Replace these parts to change die size

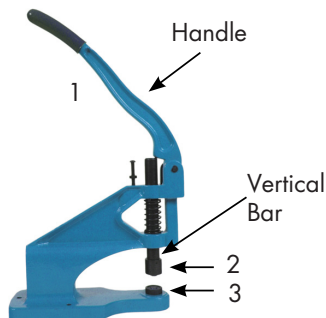

Product Set-Up

Step 1

Remove all parts from the box and place on a clean, flat surface.

Step 2 - Optional

Carefully select the permanent location for the Grommet Machine (1). With the Grommet Machine (1) in position, mark the placement of the holes. Set the Grommet Machine (1) to the side, and pre-drill the holes into the work bench. Move the Grommet Machine (1) back into position and fix it in place with appropriate length screws to get a solid grip into the workbench.

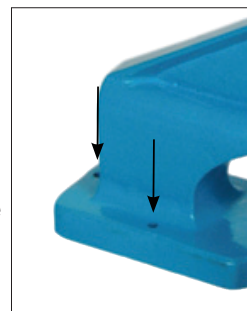

Step 3

Select the correct size Grommet Die to fit your Grommets (the Grommet Machine (1) comes standard with a #2 Grommet Die, other sizes sold separately).

Attach the Grommet Die to the Grommet Machine (1) by screwing the Top Grommet Die (2) into the hole in the bottom of the vertical bar on the Grommet Machine (1), and by screwing the Bottom Grommet Die (3) into the hole in the base. (Other dies are replaced in the same fashion.)

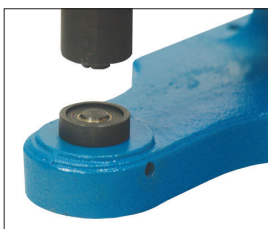

Step 4

Holding the Male Grommet, with the piercing shaft facing down, place it on the bottom side of the Top Grommet Die (2). The Top Grommet Die should hold the Grommet in place.

Place the Female Grommet with the smooth side facing down into the tray on the Bottom Grommet Die (3).

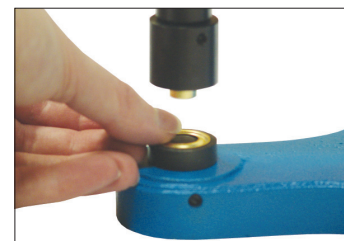
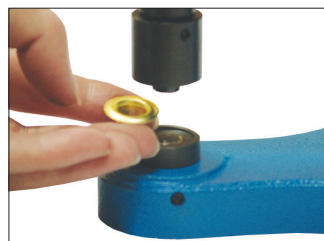

Display Set-Up Continued...

Step 5

Place the material between the Grommet Dies (2,3) and align the desired location of the Grommet with the piercing shaft of the Male Grommet.

Firmly press down on the Handle. (You will have to exert some force in order to fully pierce the material and bond the grommets.)

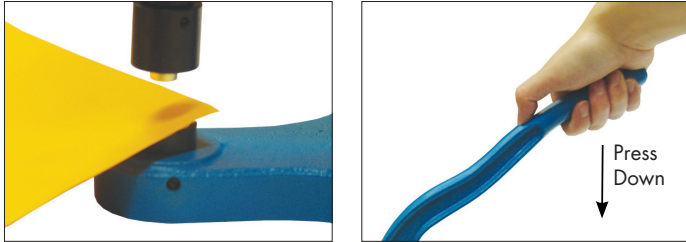

Step 6

Repeat Steps 4 and 5 for all other desired grommet locations.

Step 7

Remove the residual material from the center of the Grommets.

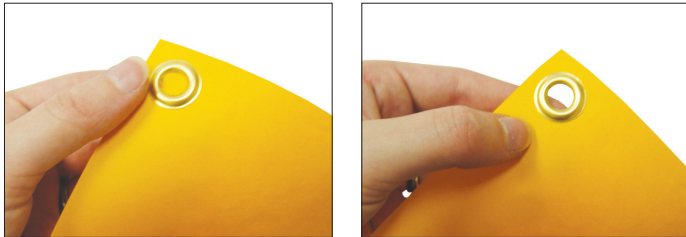

Storage

Place all product parts into box and store in a cool, dry location or leave fixed to work bench.

Care

To clean, wipe with damp cloth.

Warranty Information: All products are designed to provide the user with a cost-effective and durable product. Standard warranty is a 'one year parts and labor' warranty which warrants product against defects in material and workmanship. It does not cover damage due to accidents, abuse, or normal wear and tear. Products found to be defective will be replaced or repaired at factory's discretion.